

Parson Pendant

P1500 **1.0**

GENERATION LIGHTING

Pendant

GENERAL PRODUCT INFORMATION:

These fixtures are intended to be installed utilizing NEC compliant junction boxes.

This product is safety listed for damp locations.

Incandescent lamps may be dimmed with a standard incandescent dimmer. LED lamps may be dimmed with a LED dimmer. Consult lamp manufacturer for additional information.

CAUTION - RISK OF FIRE
 This product must be installed in accordance with the applicable installation code by a person familiar with the construction and operation of the product and the hazards involved.
Use minimum 90°C supply conductors.

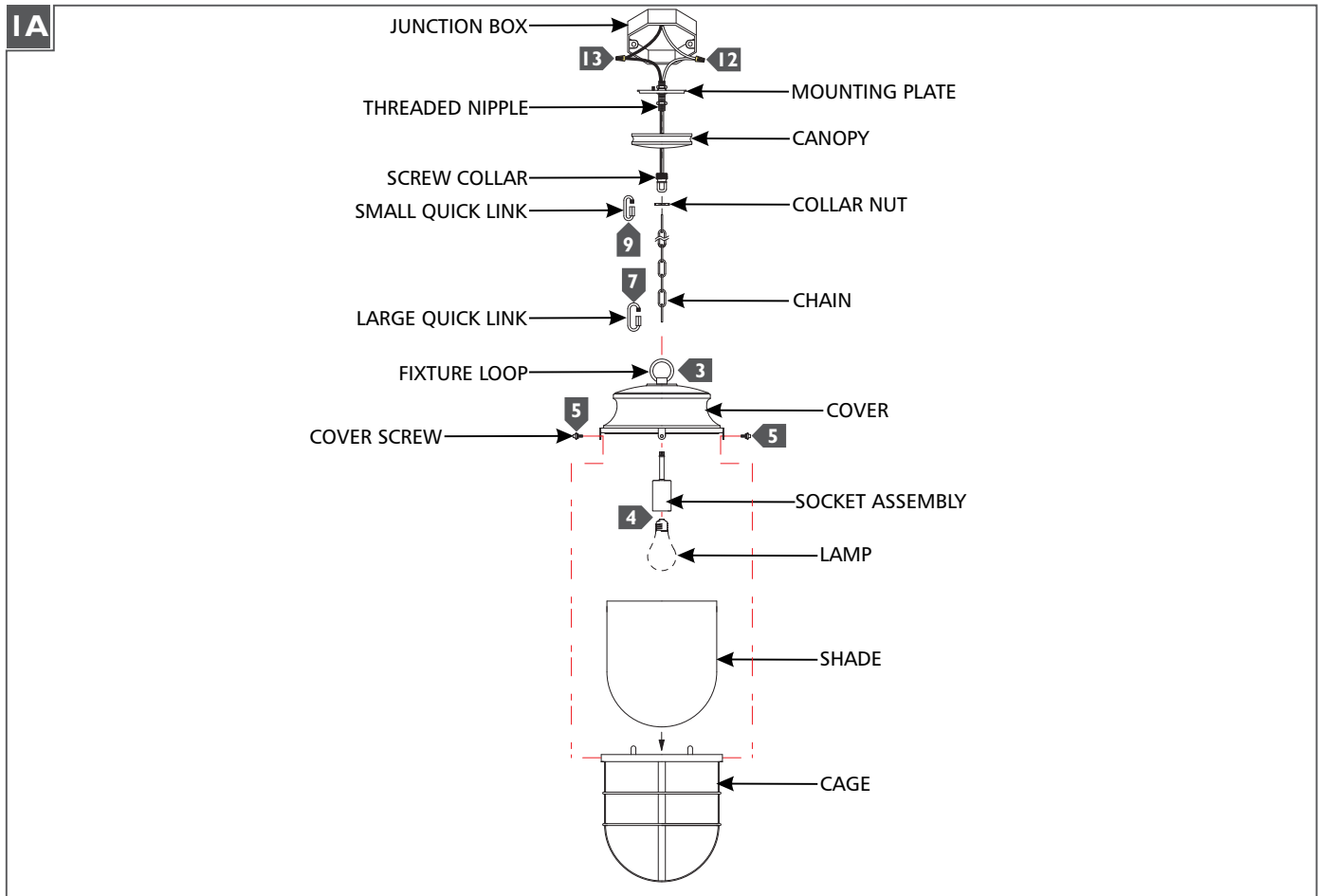

- 1** If necessary, screw the short end of the threaded nipple tightly onto the mounting plate and the screw collar onto the threaded nipple.
- 2** Secure the mounting plate to the junction box.
- 3** Feed the cord through the cover and fixture loop, then slide the cover onto the socket assembly nipple and secure them together by tightening the fixture loop onto the nipple.
- 4** Screw the lamp into the socket. Refer to the label on the lamp socket for Max Wattage information.
- 5** Insert the shade into the cage, then align the holes on the cage with the holes on the cover and secure them together using the cover screws.
- 6** Determine the wanted height of the fixture and remove a portion of the chain from the bottom by opening a link with pliers.
- 7** Install the large quick link to bottom end of the chain, then secure the large quick link onto the fixture loop.
- 8** Unscrew the collar nut from the screw collar, then install the collar nut and the canopy onto the chain (in that order).
- 9** Install the small quick link onto the remaining end of the chain, then secure the small quick link onto the screw collar.
- 10** Weave the cord through the chain, collar nut, canopy, screw collar, threaded nipple, and out of the junction box. Trim the cord leaving enough to make electrical connections.
- 11** Connect the fixture to a suitable ground in accordance to local electrical codes.
- 12** Connect the white fixture wire (square and/or rigid) to the neutral power line wire with a wire nut.
- 13** Connect the black fixture wire (round and/or smooth) to the hot power line wire with a wire nut.
- 14** Neatly place all the wires into the junction box, place the canopy onto the mounting plate, and secure it in place by screwing the collar nut tightly onto the screw collar.

SAVE THESE INSTRUCTIONS!

GENERATION LIGHTING

7400 Linder Ave, Skokie, IL 160077

800.969.3347

www.generationlighting.com

© 2019 Generation Lighting. All rights reserved.

The "Generation Lighting" graphic is a registered trademark of Generation Lighting. Generation Lighting reserves the right to change specifications for product improvements without notification.